



Electro-Voice®
Telex Communications, Inc.
600 Cecil Street
Buchanan, Michigan 49107
Phone: 616-695-6831
FAX: 616-695-4743

SERVICE DATA

682
(1682-3156)

682S
(1682-3157)

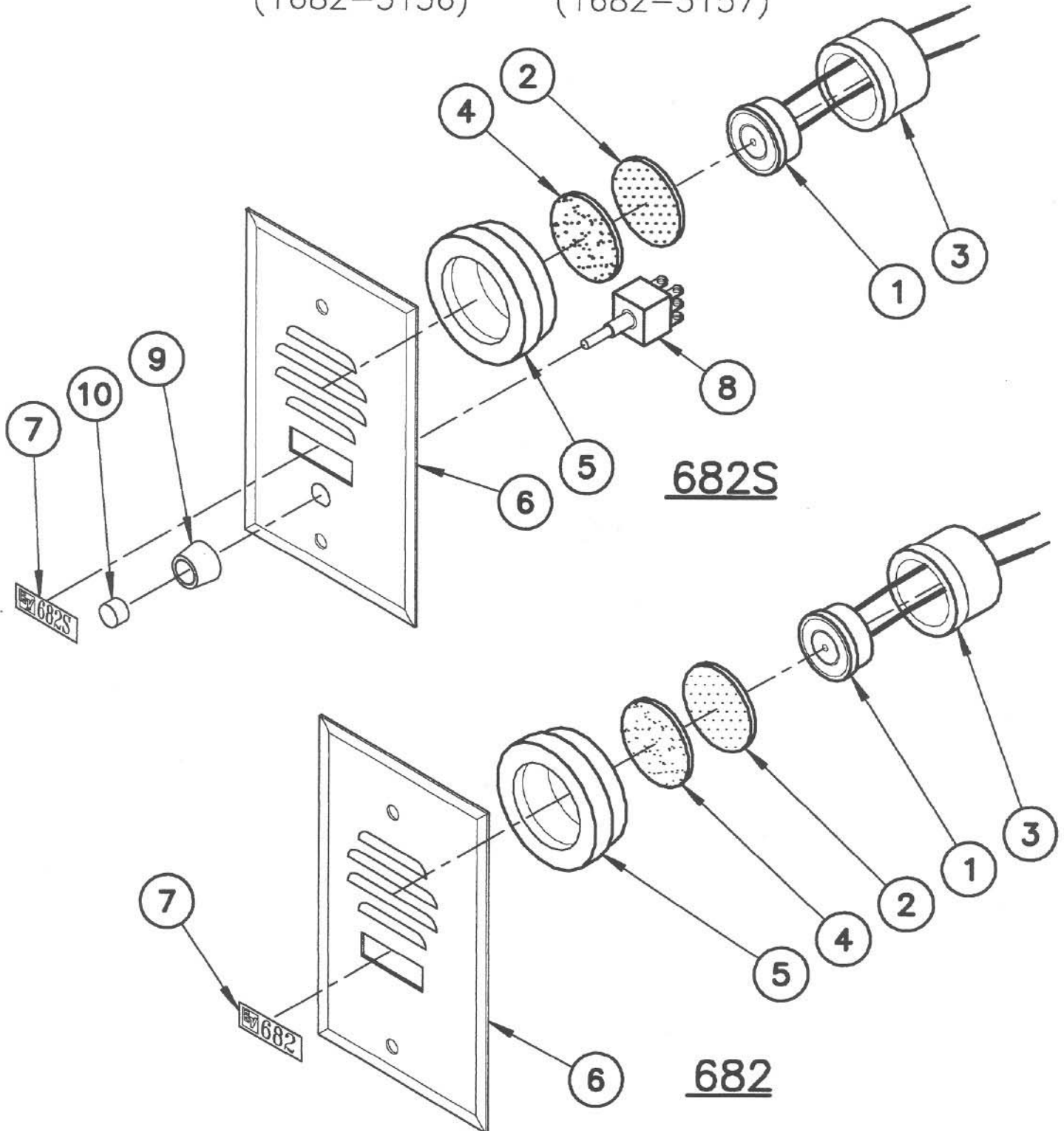

TOOLS REQUIRED:

NEEDLE NOSE PLIERS
LOW-WATTAGE SOLDERING IRON
MEDIUM FLAT BLADE SCREWDRIVER

CHEMICALS REQUIRED:

ISOPROPYL (RUBBING) ALCOHOL
RTV 118, TELEX #25400-048
ECCOBOND #45 RESIN, CLEAR, TELEX #25400-062
ECCOBOND #15 CATALYST, CLEAR, TELEX #25400-063
(MIX RESIN AND CATALYST AT A RATIO OF 150 PARTS CATALYST TO 100 PARTS RESIN)

INSTRUCTIONS:

1. CLEAN SURFACES WITH ALCOHOL BEFORE BONDING ITEM 5 TO ITEM 6.
2. ROLL RIM OF ITEM 3 OVER ITEM 2 AND ITEM 1. SEAL LEADS AND LEAD EXITS OF ITEM 3 WITH RTV 118 (TELEX #25400-048).

PARTS LIST

QUANTITIES SHOWN ARE FOR ONE COMPLETE UNIT

ITEM	682 TELEX PART NO.	682S TELEX PART NO.	QTY.	DESCRIPTION
1	02189	02189	1	TRANSDUCER
2	04125-1	04125-1	1	GRILLE, BLACK
3	46108-3	46108-3	1	REAR CUP
4	70664-000	70664-000	1	WIND SCREEN
5	46106	46106	1	SHOCK MOUNT
6	70667-001	70067-002	1	WALL PLATE
7	535122	535123	1	LABEL, PRODUCT
8	N/A	57621-000	1	SWITCH
9	N/A	57621-001	1	SWITCH COLLAR
10	N/A	57621-002	1	SWITCH BUTTON, BLACK